

2024 ASPHALT REPAIRS

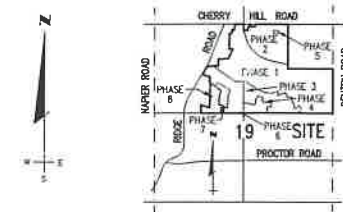

LOCATION MAP
NO SCALE

CHERRY HILL VILLAGE

LEGEND		
EXISTING	DESCRIPTION	NUMBER
⊙	"STOP SIGN"	93
⊘	"NO PARK"	126
⊞	"STREET NAME"	51
⊞	"SPEED LIMIT 25"	32
⊞	"ONE-WAY"	7
⊞	"ONE-WAY" "DO NOT ENTER"	2
◇	"ROAD ENDS"	1
⊞	"NO PARKING BETWEEN SIGNS"	4
TOTAL NUMBER OF EXISTING SIGNS		316
— — — — — EXISTING WATER MAIN		

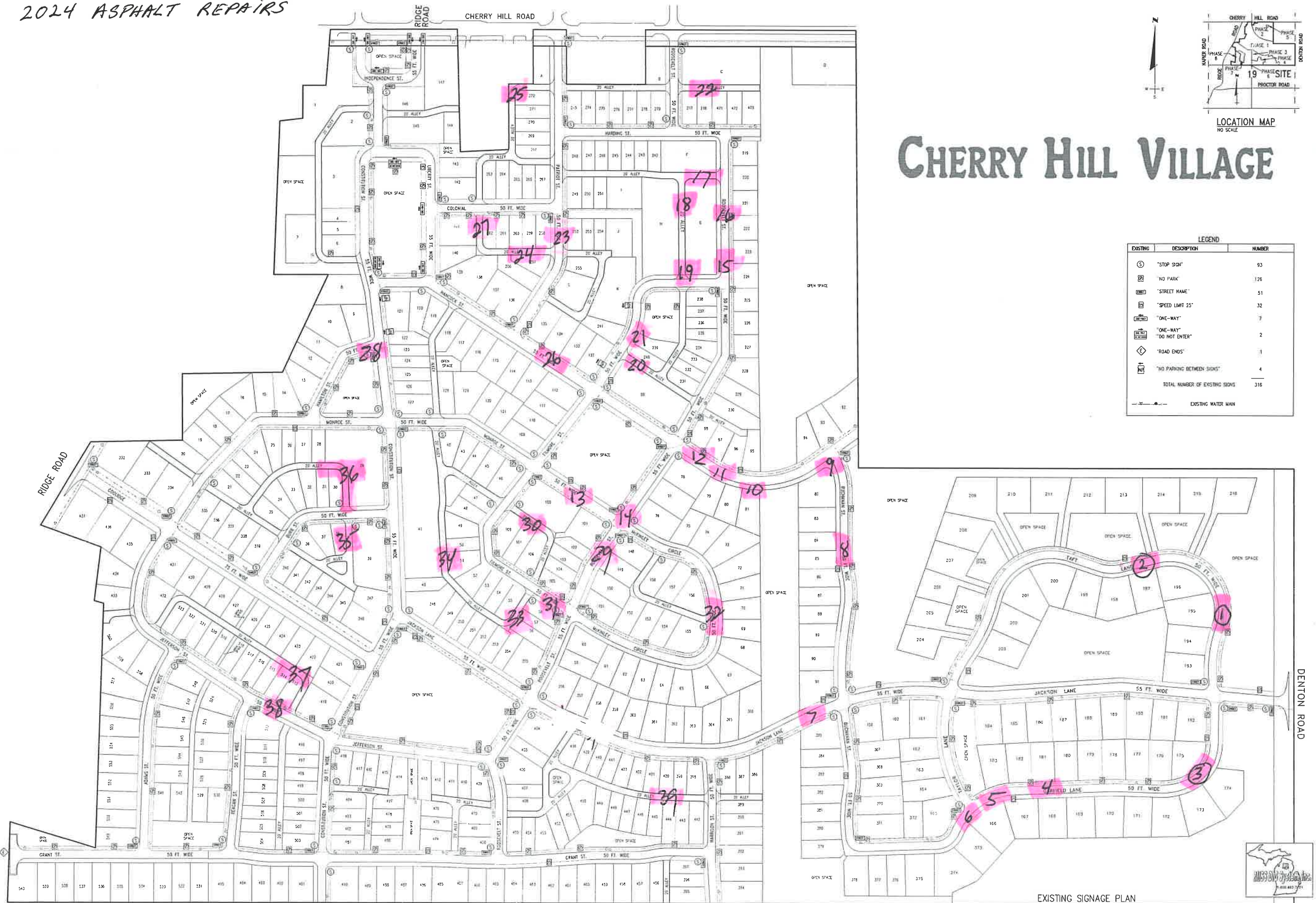

EXISTING SIGNAGE PLAN

FOR CHERRY HILL VILLAGE H.O.A. C/O HERBMAN & ASSOCIATES, P.C. 4186 WILCOX ROAD 75 NORTH MI 43770 (313) 455-5442 REPRESENTATIVE: MR. DANIEL A. HERBMAN	DATE: FEBRUARY 08, 2014 REVISIONS: UPDATED PLAN PER HGA 03/25/15	CHERRY HILL VILLAGE PART OF THE N.W. 1/4 & N.E. 1/4 OF SECTION 19, T. 2 S., R. 8 E., CANTON TOWNSHIP, WAYNE COUNTY, MICHIGAN	WARNER, CANTRELL & PADROS, INC. CIVIL ENGINEERS & LAND SURVEYORS 27275 Wagon Wheel Drive #7 Farmington Hills, MI 48334 (248) 862-1888
	AS BUILT	SCALE: 1" = 100' DATE:	PLAN FILE: 20140208_3006-21 EX 3006.plt JOB NO.: 20140208 PLAN FILE: 14-513-F171

\L0070222-14-dm\Land\Project\2014\20140208-3006-21 EX 3006.plt, 2/11/14 10:51:13 AM, DWG TO PDF.dwg